

THIS DRAWING IS UNPUBLISHED. RELEASED FOR PUBLICATION 20
 © COPYRIGHT 20 BY - ALL RIGHTS RESERVED.

LOC		DIST		REVISIONS			
P	LTR	DESCRIPTION	DATE	DWN	APVD		
	A	RELEASED PER ECR-12-003396	21FEB2012	F.L	S.Y		
	AI	RELEASED PER ECO-12-017456	29SEP2012	F.L	S.Y		

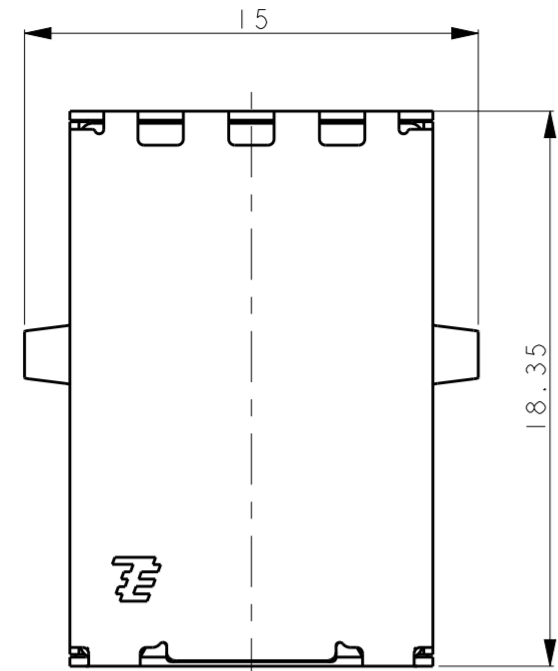

PIN NO.	SIGNAL NAME	REMARK
1	VBUS	USB 2.0 CONTACT PINS
2	D-	
3	D+	
4	GND	
5	StdB_SSTX-	USB 3.0 CONTACT PINS
6	StdB_SSTX+	
7	GND_DRAIN	
8	StdB_SSRX-	
9	StdB_SSRX+	

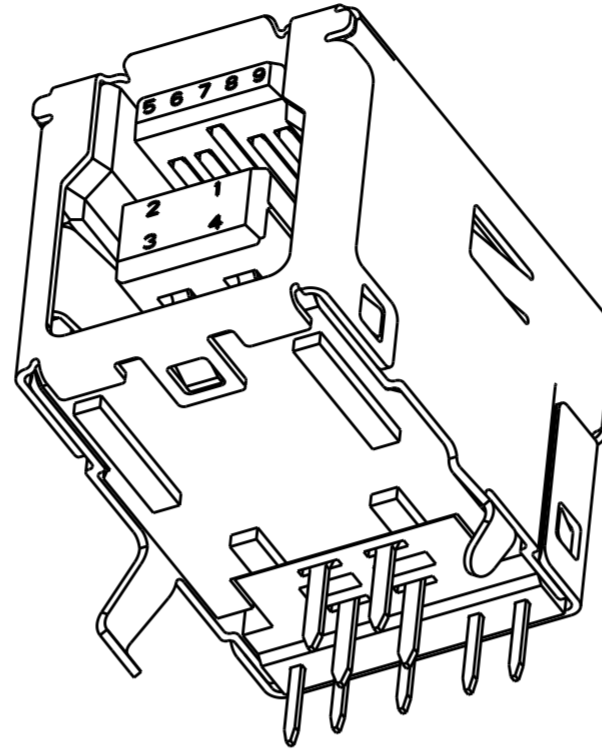

- 1 MATERIAL:
SHELL & CONTACTS: COPPER ALLOY.
HOUSING & TINE PLATE: THERMOPLASTIC.
- 2 PLATING:
CONTACT PLATING: 0.76um MIN. GOLD ON MATING AREA.
2.54um MIN. MATTE TIN ON SOLDER TAILS.
1.27um MIN. NICKEL UNDER PLATING.
SHELL PLATING: SOLDERABILITY NICKEL.
- 3 PLATING:
CONTACT PLATING: 0.38um MIN. GOLD ON MATING AREA.
2.54um MIN. MATTE TIN ON SOLDER TAILS.
1.27um MIN. NICKEL UNDER PLATING.
SHELL PLATING: SOLDERABILITY NICKEL.
- 4 PLATING:
CONTACT PLATING: GOLDEN FLASH ON MATING AREA.
2.54um MIN. MATTE TIN ON SOLDER TAILS.
1.27um MIN. NICKEL UNDER PLATING.
SHELL PLATING: SOLDERABILITY NICKEL.
- 5 DATUM AND BASIC DIMENSIONS ESTABLISHED BY CUSTOMER.
- 6 RECOMMENDED PC BOARD THICKNESS OF 1.60.

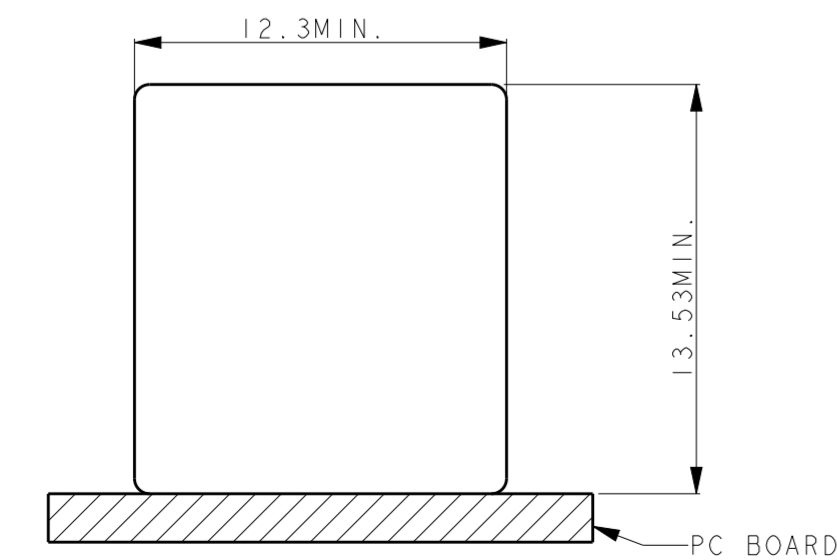
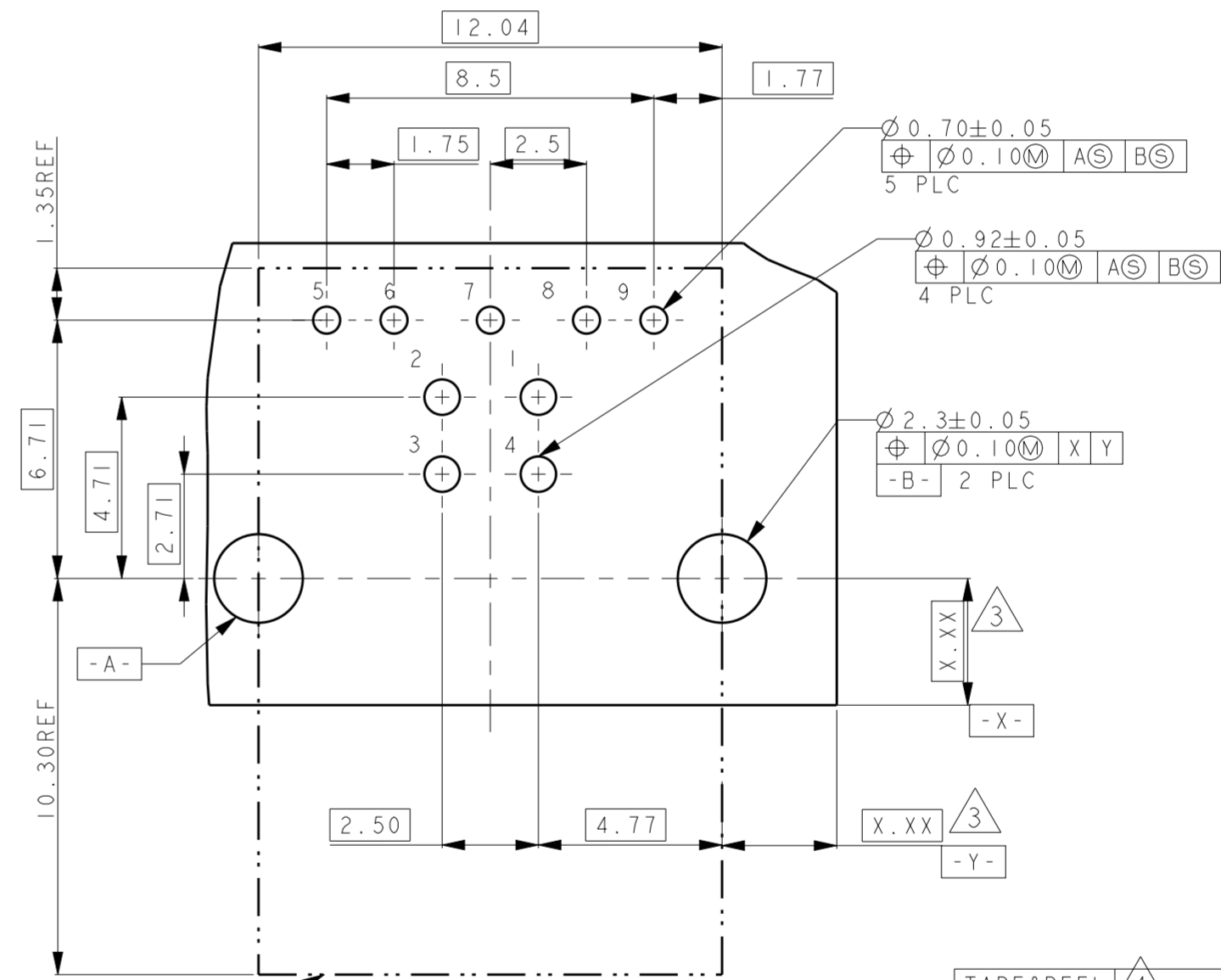
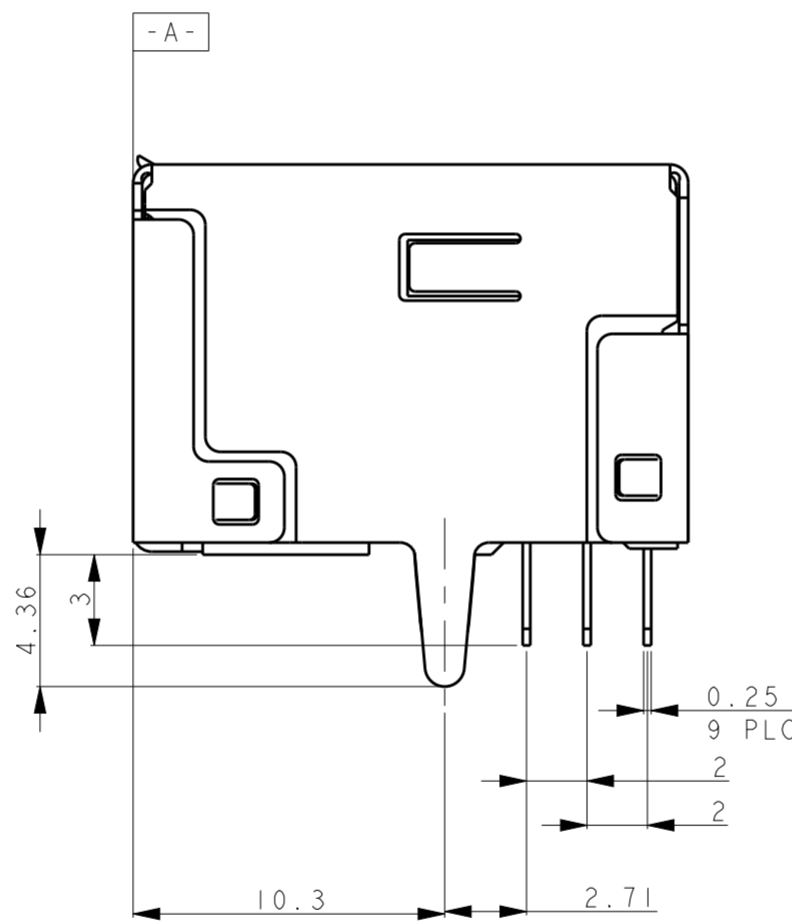
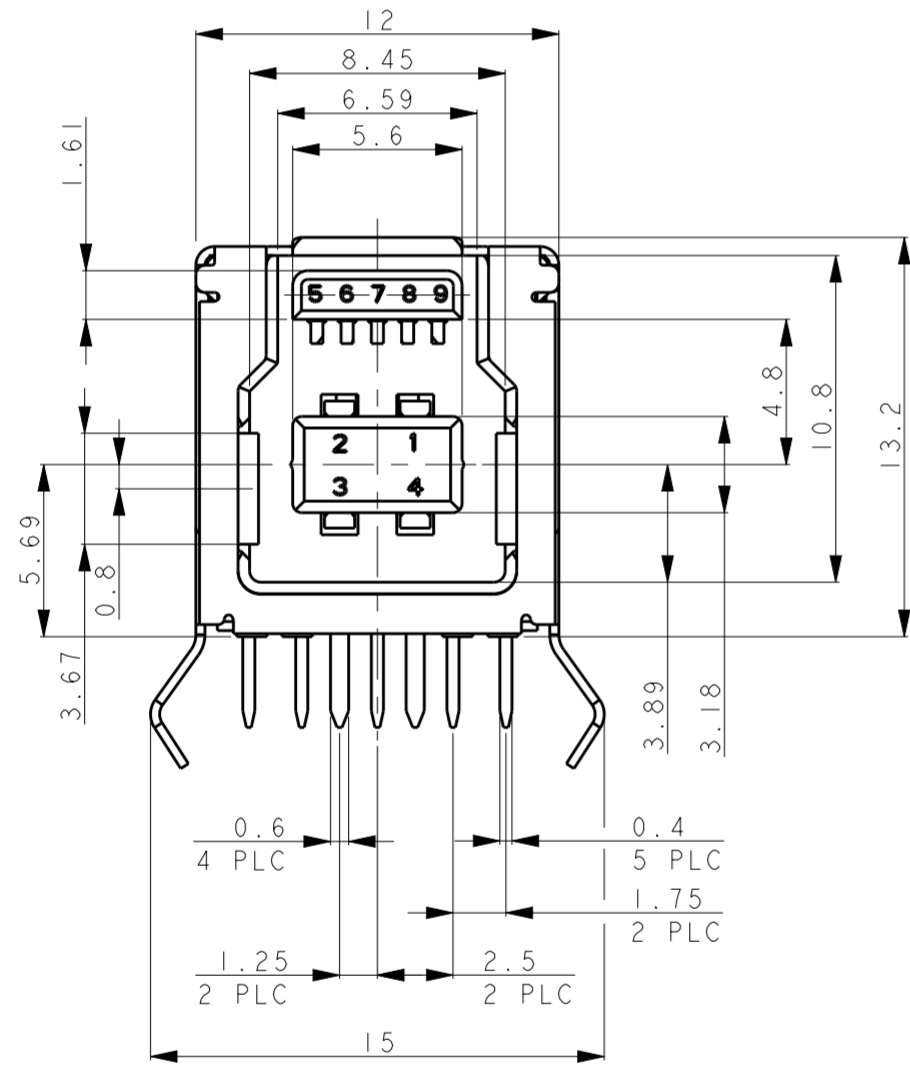

CONNECTOR EDGE LINE FOR REFERENCE

RECOMMENDED PCB LAYOUT (CONNECTOR MOUNTING SIDE VIEW) TOP VIEW

TAPE&REEL	4	3	1	1	1	1
TAPE&REEL						
TAPE&REEL						
TRAY						
TRAY						
TRAY						
PACKAGE						
FINISH						
MATERIAL						
PART NUMBER						

THIS DRAWING IS A CONTROLLED DOCUMENT.		DWN FRANCIS LEE 21FEB2012
DIMENSIONS: mm		CHK XIANG XU 21FEB2012
TOLERANCES UNLESS OTHERWISE SPECIFIED:		APVD STEVEN YAO 21FEB2012
0 PLC	±0.25	PRODUCT SPEC 108-115001
1 PLC	±0.25	APPLICATION SPEC
2 PLC	±0.25	WEIGHT
3 PLC	±	Customer Drawing
4 PLC	±	
ANGLES	±1°	
FINISH		

STE TE Connectivity

NAME: USB3.0 STANDARD B TYPE RECEPTACLE

SIZE: A2 CAGE CODE: 0779 DRAWING NO: C-1932259

RESTRICTED TO: -

SCALE: 4:1 SHEET: 1 OF 1 REV: AI